

DS-PDC15-EG2-WB(B)  
Wireless Curtain Detector  
Quick Start Guide

ENGLISH

Diagram References

1 Appearance

- 1. Indicator
- 2. Bracket Tamper Port
- 3. Battery
- 4. Tamper Switch
- 5. Power Switch

2 Enrollment

3 Installation

- I. Check signal strength.
- II. Install the device.
  - a. Mount the detector with screw.
  - b. Mount the detector with sponge tape.
- III. (Optional) Install the device with bracket.

4 Test

User Manual

Scan the QR code for more information and operation help.

Specification

Detection range	15 m, 6.3°
Auto sensitivity	Yes
Tamper protection	Front & Back
LED indicator	Blue (alarm)
Operating temperature	-10 °C to 55 °C (14 °F to 131 °F) -10 °C to 40 °C (14 °F to 104 °F) Certified
Storage temperature	-20 °C to 60 °C (-4 °F to 140 °F)
Operating humidity	10% to 90%
Installation height	1.8 to 3 m (nominal mounting height = 2.4 m)
Dimension (W x H x D)	65.5 mm x 103 mm x 48.5 mm
Weight	128 g
Transmission frequency	433 MHz
RF range	1.2 Km (open area)
Battery	CR123A x 1 (included), 3V/1600 mAh
Standard battery life	5 years
Low Voltage Value	2.45 V
Voltage Range	Fully charged (new) to 2.45 VDC (battery)

Note: when the low voltage message appears there will be at least 30 days of use.

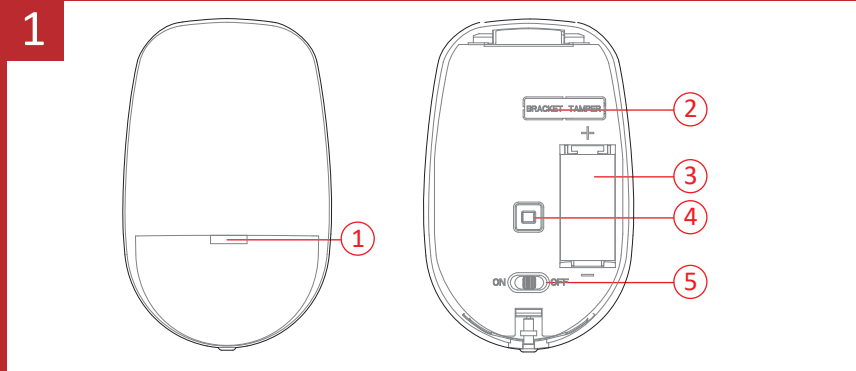

ENGLISH

**INSTALLATION CAUTION**  
The additional force shall be equal to three times the weight of the equipment but not less than 50N. The equipment and its associated mounting shall remain secure during the installation. After the installation, the equipment, including any associated mounting plate, shall not be damaged.

ESPAÑOL

**PRECAUCIONES DE INSTALACIÓN**  
La fuerza adicional debe ser equivalente a tres veces el peso del equipo, pero no inferior a 50 N. El equipo y el soporte asociado deben permanecer seguros durante la instalación. Tras la instalación, no se debe dañar el equipo ni tampoco las placas de montaje asociadas.

PORTUGUÊS (BRASIL)

**CUIDADOS NA INSTALAÇÃO**  
A força adicional deve ser igual a três vezes o peso do equipamento, mas não inferior a 50 N. O equipamento e seus recursos de montagem associados devem permanecer seguros durante a instalação. Após a instalação, o equipamento, incluindo qualquer placa de montagem associada, não pode estar danificado.

SLOVENŠČINA

**POZORI NAMEŠTITEV**  
Dodatna sila mora biti enaka trikratni teži opreme, vendar ne manjša od 50 N. Poskrbite, da med namestitvijo ne poškodujete opreme in priloženih vgradnih pripomočkov. Po končani namestitvi pazite, da ne poškodujete opreme in morebitne vgradne plošče.

SRPSKI

**UPOZORENJA O INSTALACIJI**  
Dodatna sila treba da bude jednaka trostrukoj težini opreme, ali ne manja od 50 N. Oprema i odgovarajući pribor za postavljanje treba da budu pričvršćeni tokom postavljanja. Posle postavljanja, oprema i ploča za postavljanje koju ste možda koristili ne smeju da budu oštećene.

HEBREW

**אזהרות התקנה**  
הכוח הנוסף חייב להיות שווה לפי שלושה ממשקל המשקל הציוד ולא פחות מ-50N. הציוד והאביזרים הנלווים יצטרכו להיות מוצמדו במהלך ההתקנה. לאחר ההתקנה, אין לגרום נזק לציוד, סולל למשטח ההרכבה.

မြန်မာ

**တပ်ဆင်ခြင်း သတိပြုရန်**  
အပူပေးစက်၏ အလေးချိန်ထက် သုံးဆခန့် အလေးချိန်ကို ထပ်မံပေးရမည်။ အပူပေးစက်နှင့် တပ်ဆင်ရန် အသုံးပြုသည့် ပစ္စည်းများသည် တပ်ဆင်မှုအတွင်း အပူပေးစက်နှင့် တပ်ဆင်မှုအတွင်း အပူပေးစက်ကို ဖျက်ဆီးခြင်းမှ ရှောင်ကြဉ်ရမည်။

