

Contenido:

PAQ-T5PRO-PISTON

Chapa Electromagnética
Puertas de Madera o Aluminio

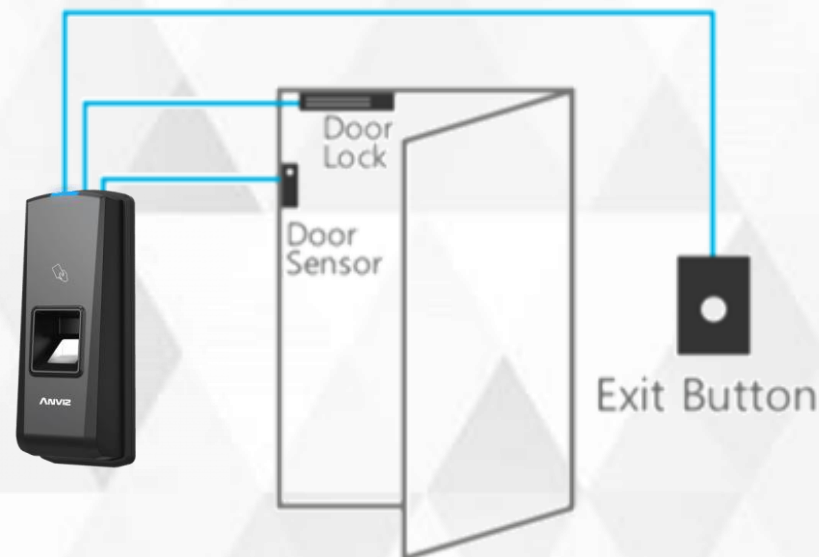

PISTÓN



CAJA
BOTON



BOTON

T5 Pro

Fingerprint & RFID Access Control



Exquisite Access Control Device

T5 Pro is the most compact access control device controller which suitable for installing on door frame. It is combined with biometric fingerprint and RFID Card for higher security requirement. With master cards, you can register or delete users under offline state. USB power supply and debug make operations simple. The most cost effective and efficient choice for you.

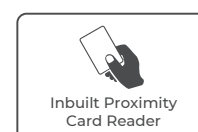
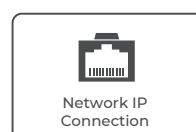

BioNANO - The core algorithm

BioNano is applied in all Anviz biometric-based products used for identification.



- Independent research and development
- Suitable for both wet and dry fingers
- Automatically heals the broken lines in fingerprint images
- Extraction of features in worn fingerprints
- Fingerprint template auto update

Technical Specifications

Item	Description
Processor	TI Stellaris® 32-Bit High Speed CPU
Optical Sensor	AFOS Optical Sensor
Auto Sensor Wake Up Mode	Yes
Scan Area	22mmx18mm
Resolution	500 DPI
Fingerprint Capacity	5000
Log Capacity	50000
Identification Mode	FP, Card, FP+Card
Identification Time	<0.5s
FRR	0.001%
FAR	0.00001%
Communication Interface	RS485, USB Plug & Play, TCP/IP
Card Reader Module	Standard EM RFID, Optional Mifare Card
Relay	1 Relay
Certificate	FCC, CE, ROHS
Wiegand	Wiegand26 Output
Door Open Sensor	Yes
Size(LxWxH)	145mmx55mmx37mm

Features

- ▶ Small size with compact design
- ▶ Easy installation
- ▶ New generation sensor – hermetic, waterproof and dustproof
- ▶ BioNANO core fingerprint algorithm: High Performance and Reliability
- ▶ Easy user enrollment on the unit via Master Card or in the management software
- ▶ Identification mode: Fingerprint, Card, Fingerprint + Card
- ▶ Compatible with industrial standard RFID EM & Mifare
- ▶ Communicate with computer via TCP/IP, RS485 and Mini USB port
- ▶ Directly connect to lock control and door open sensor as a standalone access controller
- ▶ Standard Wiegand26 output
- ▶ Optional waterproof cover for outdoor solution
- ▶ Various communications(TCP/IP, RS485) are appropriate for multiple network deployment

Network Topology Illustration

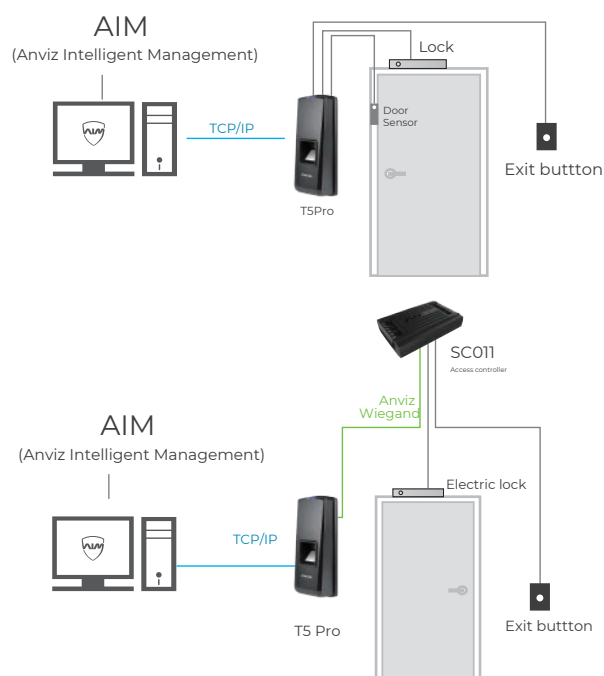

CrossChex

Time Attendance and Access Control
Management System



Employee
Unify Employee management



Device
Quick Add, Easy Setting



Shift
Manual and intelligent
shift schedule



Export
Flexible and Practical
Report output



Easy to
Operate



Simple to
Install



Enhanced
Security



Types of
Reports

For more information, visit www.anviz.com, or email us sales@anviz.com.

2020© Anviz Global. All Rights Reserved. Due to the consistent improving of the product, this specification and appearance is subject to change without notice.